

## Economy Ball Valve, Standard Port, Sizes 1/4" ~ 2"



The SVF Series REV standard port ball valves are designed for general purpose performance in a wide variety of utility applications. The REV is an economical, manually operated valve that meets industry requirements for performance and dependability.

### REV DESIGN FEATURES

- ✓ 316 Stainless Steel body, ball and stem
- ✓ Pressure rated for 800 WOG
- ✓ Designed & built for economical performance
- ✓ Threaded end connectors
- ✓ Lightweight and economical
- ✓ Vinyl grip handle
- ✓ Blowout proof stem adds safety & reliability
- ✓ Lockable in the "Open" or "Closed" position

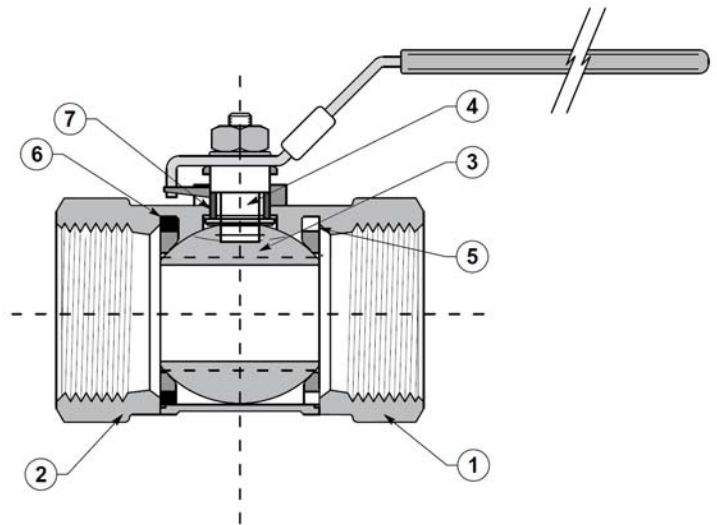

### MATERIALS OF CONSTRUCTION

ITEM	DESCRIPTION	MATERIALS SPECIFICATIONS
1	Body	316 Stainless Steel (ASTM A351 CF8M)
2	End Connector	316 Stainless Steel (ASTM A351 CF8M)
3	Ball	316 Stainless Steel
4	Stem	316 Stainless Steel
5	Seat	RTFE
6	Body Seal	PTFE
7	Stem Seal	PTFE

### SPECIFICATION STANDARDS OF COMPLIANCE

SVF Series REV Ball Valves are available in designs that meet the following Industry Standards:

- ANSI
- NACE
- DIN
- ASME
- ASTM
- ISO
- API
- MSS

Contact SVF for specific applications

*What do you need today?*™

**HIGH PURITY**  
**CleanFLOW**  
[www.CleanFLOW.net](http://www.CleanFLOW.net)

**PRO-SPEC**  
 PROCESS SPECIFIC  
[WWW.PRO-SPEC.NET](http://WWW.PRO-SPEC.NET)

**QUALITY FLOWS**  
 THROUGH US

## Economy Ball Valve, Standard Port, Sizes 1/4" ~ 2"



### DIMENSIONS, WEIGHT, Cv

Size	A		B		D		L		Weight.		Cv
	in.	mm	in.	mm	in.	mm	in.	mm	lbs	kg	
1/4"	1.54	39	0.20	5.0	2.72	69	1.38	35	0.15	0.07	3.8
3/8"	1.73	44	0.28	7.2	3.11	79	1.42	36	0.25	0.11	8.2
1/2"	2.25	57	0.36	9.2	4.29	109	1.57	40	0.38	0.16	13.8
3/4"	2.32	59	0.49	12.5	4.29	109	1.65	42	0.55	0.25	26.5
1"	2.80	71	0.59	15.0	4.41	112	1.85	47	0.95	0.43	39.7
1-1/4"	3.07	78	0.79	20.0	4.41	112	2.09	53	1.54	0.69	72.2
1-1/2"	3.27	83	0.98	25.0	6.18	157	2.44	62	1.87	0.84	115.4
2"	3.94	100	1.18	32.0	6.18	157	2.64	67	2.86	1.29	198.8

### REV - PRESSURE/TEMPERATURE CHART

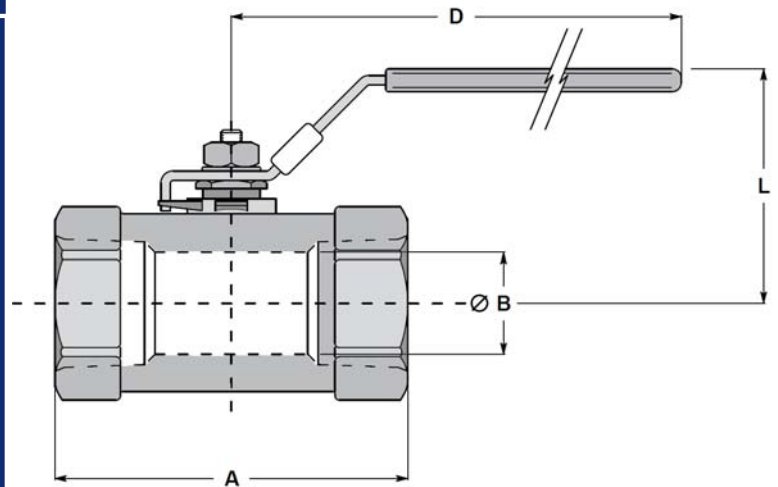
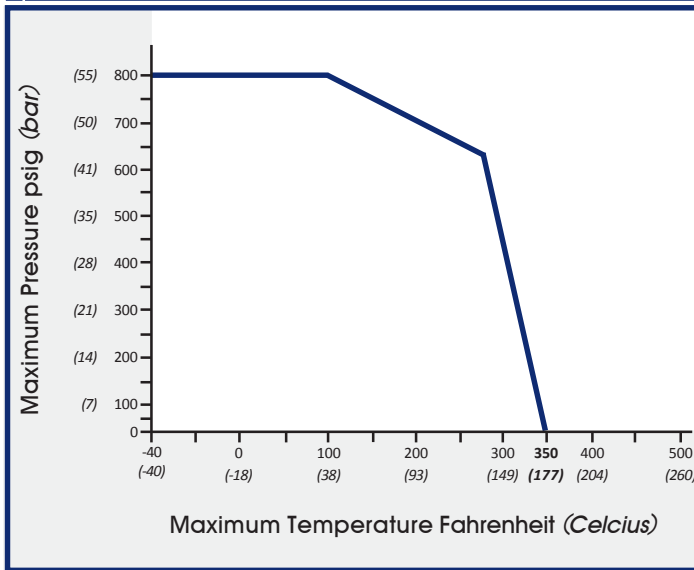

### HOW TO ORDER SERIES REV BALL VALVES

SERIES	BODY MATERIAL	END MATERIAL	SEAT	BODY SEAL	ENDS	SIZE	
REV	66 = 316 Stainless Steel ASTM A351 CF8M	66 = 316 Stainless Steel	R = RTFE	T = PTFE	SE = Screwed Ends (FNPT)	02 = 1/4"	10 = 1"
						03 = 3/8"	12 = 1-1/4"
						05 = 1/2"	15 = 1-1/2"
						07 = 3/4"	20 = 2"
<b>Order Example: (REV6666RTSE05)</b>							
<b>Example Description: 316 Stainless Steel Body &amp; Ends, Stainless Steel Ball &amp; Stem, RTFE Seat, PTFE Body Seal, Screwed Ends (FNPT), 1/2" Size</b>							
REV	66	66	R	T	SE	05	

Subject to revision. Please visit [www.SVF.net](http://www.SVF.net) for the latest updates on this Data Sheet. All Data Sheets posted on our website supersede all prior publications • [Document #DDS-REV-07-2010 • Series REV Data Sheet • 07/19/2010]